

WALKIE REACH STACKER

MODEL RRS 30

Raymond® Walkie Reach Model RRS30. Do the job in less time for less money. Whether you are trying to improve productivity, reduce maintenance costs, or perform more tasks with one truck, the *Raymond* RRS is the solution. This highly maneuverable stacker is the perfect vehicle for retail storage areas, weight restricted elevators and floors, and other specialized operations. The versatile RRS can accomplish all of your staging and dock-to-stock needs. The easy-to-use controls and ergonomic control handle provide maximum simplicity and smooth operation, increasing operator confidence. Variable speed control levers make load handling easier and more precise, which enhances productivity and reduces rack damage. Modular components, state-of-the-art transistor controls, and heavy-duty construction make the *Raymond* RRS easy to maintain and economical to own.

RRS30 Standard Equipment:

- › 3000 pound maximum capacity
- › Two and three stage masts with fork heights up to 189"
- › Load sensing torsion bar suspension for easier steering
- › Separately excited traction system for smooth acceleration
- › Thumb wheel control
- › Key switch
- › Horn
- › Handle mounted electric lift/lower for easy access
- › Chassis mounted manual lift/lower for precise control
- › Tilt carriage
- › 48" high load backrest
- › Hour meter



RAYMOND
Above. And beyond.®

WALKIE REACH MODEL 30

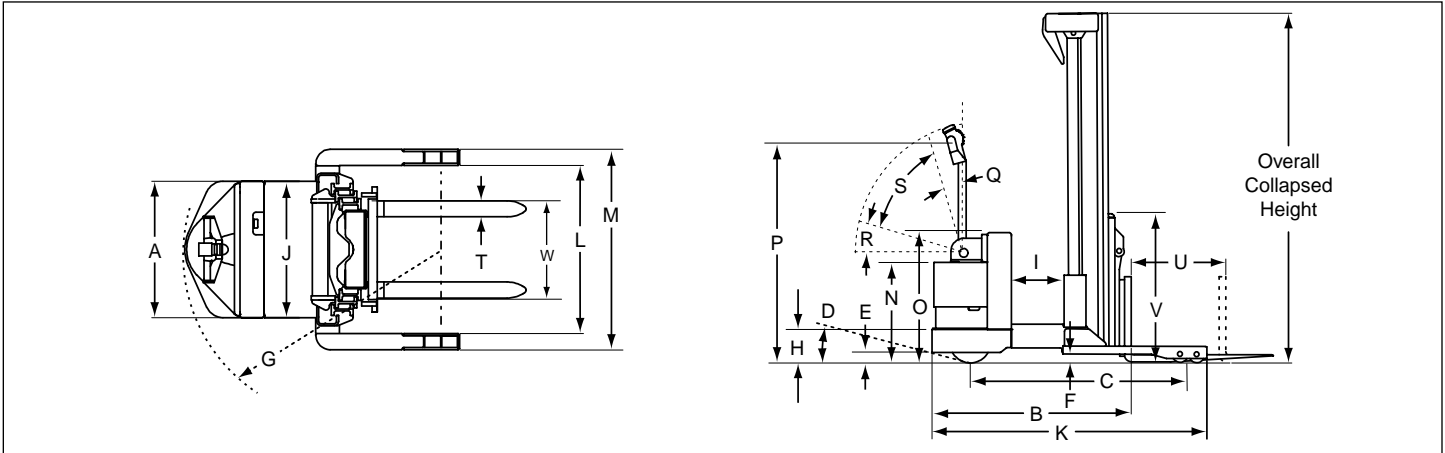

MAST SPECIFICATIONS				
Lift Height (in.)	Lift Height (in.)	Overall Collapsed Height (in.)	Free Lift (in.)	Capacity (lbs.)*
2-stage	3-Stage			
100		71	6	3000
124		83	6	3000
150		95	6	2750
	150	71	53	2750
	180	83	65	2100
	189	87	69	2000

* Deduct 250 lbs. with sideshift

PERFORMANCE SPECIFICATIONS			
			RRS30
Truck Weight, less battery	lbs.		3500
Battery Connector			SB-175 red
Battery Lead Position/Length	in.		B/20
Battery Voltage	V		24
Minimum Battery Weight	lbs.		950
Travel Speed	empty/loaded	mph	3.2/2.8
Lift Speed	empty/loaded	fpm	46/29
Lowering Speed	empty/loaded	fpm	47/60

AISLE WIDTH REQUIRED FOR RIGHT ANGLE STACKING			
Load Width (in.)	RRS30		
	Load Length (in.)		
	42	48	
30	85	92	
32	84	92	
36	84	91	
40	83	91	
42	83	90	
48	82	90	

Aisle width requirements based on 6" clearance between pallets.
Add 6-12" for ease of operation. Add 4.5" for 3-stage mast.

DIMENSION CHART		
		RRS30
Capacity	lbs.	3000
Tilt (Backward/Forward)	deg.	4/3
A Tractor Width	in.	34.1
B Tractor Head Length — 2-stage/3-stage	in.	47.4/50.6
C Wheelbase	in.	55.3
D Grade Clearance	%	10
E Underclearance: Tractor	in.	2.1
F Underclearance: Baselegs	in.	2
G Turning Radius	in.	65
H Battery Floor Height with optional rollers	in.	9.5
I Battery Compartment Width	in.	13.3
J Battery Compartment Length	in.	32.3
K Overall Length (without forks)	in.	69.75
L Baseleg Opening (inside)	in.	32-50
M Baseleg (outside)	in.	40-58
N Tractor Height at Handle	in.	25.25
O Tractor Height at Battery	in.	32.25
P Handle Height Retracted	in.	55.6
Q Top Vertical Braking Arc	deg.	12.5
R Bottom Braking Arc	deg.	10.5
S Handle Operating Arc	deg.	67
T Forks	in.	1.75 x 4
U Reach Distance — 2-stage/3-stage	in.	24
V Load Backrest (height)	in.	48
W Fork Adjustment	in.	12-30
Drive Tire	in.	10.5 x 5 polyurethane
Load Wheels	in.	4 x 2.875 tandem polyurethane

Due to continuous product improvement, specifications are subject to change without notice or obligation. Some systems and features shown are optional at extra cost. Raymond and Above. And beyond. are U.S. trademarks of The Raymond Corporation.

©2012 The Raymond Corporation
PO Box 130, Greene, NY 13778-0130
www.raymondcorp.com | Toll free 1-800-235-7200
SIFB-0087 0812VP-2.5

RAYMOND
Above. And beyond.®